



ASCENSOR
DE OBRA

SC
SERIES

SC SERIES CONSTRUCTION HOIST

SC Series construction hoist is the one of domestically leading technology that well designed and manufactured by **ZOOMLION**, also strictly tested and supervises by China Construcion Machinery Test Center. Compared to other vertical transport equipment, it features reliable performance, high safety, energy saving flexible transporting, as well as easy, assmby & disassembly and wide application. As safe and efficient vertical access equipment in construction field, it largely reduces the labor intensity in tune with the developing trend.

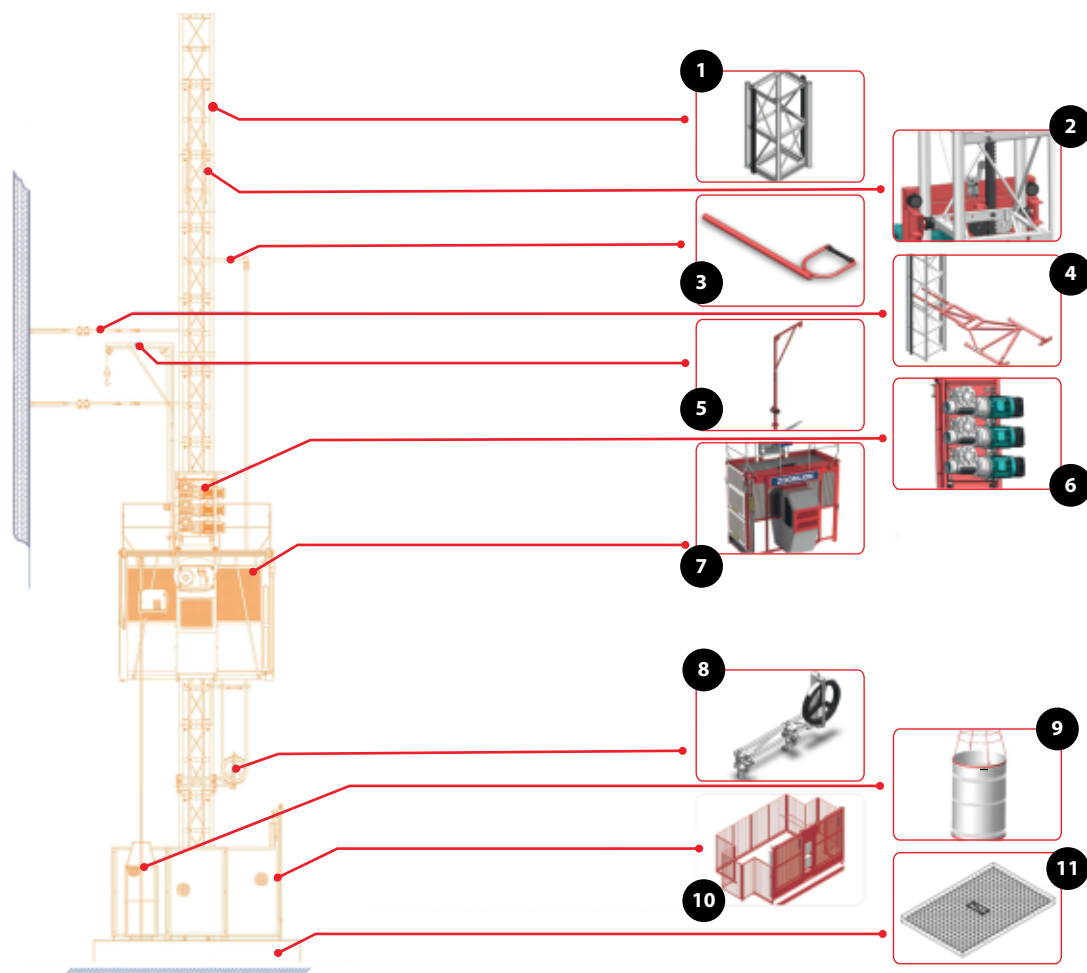

SC Series Construction Hoist Sketch

- | | |
|---------------------------------------|--------------------------------|
| 1 MAST | 6 DRIVING SYSTEM |
| 2 DERAILMENT PREVENTION DEVICE | 7 CAGE |
| 3 CABLE GUIDE | 8 CABLE PULLEY |
| 4 MAST - TIE | 9 CABLE DRUM |
| 5 ELECTRIC LIFTING DEVICE | 10 BASE FRAME ENCLOSURE |
| | 11 CONCRETE FOUNDATION |

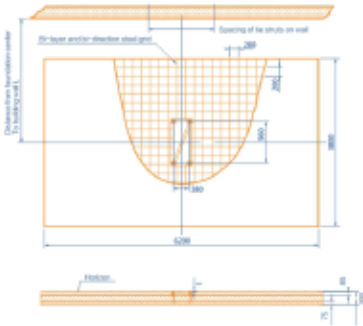

- 1 Concrete foundation with steel grid, is placed in top and bottom layers. The steel angle of embedded frame is welded to the top layer of steel grid, while the hook of embedded frame hooks up the bottom layer of steel grid.
- 2 The earth endurance shall satisfy as below
When tower height < 100m, the earth bearing capacity > 0.1MPa
When 100m < tower height < 300m, the earth bearing capacity > 0.15MPa
When 300m < tower height < 500m, the earth bearing capacity > 0.2MPa
- 3 The cement used in concrete foundation shall apply concrete >C30
- 4 The surface of concrete foundation shall be even with horizontal deviation not more than 1mm/m;
- 5 In case of the surface of the concrete foundation lower the ground level, water ways (drains) shall be equipped around the foundation.

Mast - tie	Distance from foundation center to building wall L (mm)	Spacing of tie struts on wall W (mm)
Type II A	2800 - 3200	1500
Type II B	3000 - 3600	1750
Type II C	3400 - 4200	2000
Type II D	3000 - 3600	1500

Technical Data (General type)

Designation Series	SC100	SC100/100	SC200	SC200/200	SC200/200E	Note
Rate load (kg)	1000/12 person	2x1000/2x12 person	2000/24 person	2 x 2000/24 person	2 x 2000/ 2 x 24 person	
Erecting payload (kg)	800	800	1000	2 x 1000	2 x 1000	
Rated speed (m/min)			36			
Reduction ratio			1:16			
Max.lifting height(m)			450			
Cage size(L x W x H)(m)			3.1 x 1.5 x 2.5			
Power supply (V)			380v + 5% 50Hz			
Motor power (kW)	2 x 11	2 x 2 x 11	3 x 11	2 x 3 x 11	2 x 2 x 13	JC=25%
Rated current (A)	2 x 24	2 x 2 x 24	3 x 24	2 x 3 x 24	2 x 2 x 27	
Power capacity (KVA)	34	2 x 34	49	2 x 49	2 x 35	
Mast section	Wall thickness of corner bar (chord member)		Weight of mast section		Dimension of mast section	
	t4.5		145			650 x 650x 1508
	t6.0		160			
	t8.0		180			
t10.0		195				
Cage weight (incl. driving system)(kg)	1900	2 x 1900	2000	2 x 2000	2 x 2000	
Safety device type	SAJ30 - 1.2	SAJ30 - 1.2	SAJ40 - 1.2	SAJ40 - 1.2	SAJ40 - 1.2	



Technical Data (Frequency Control type)

Designation Series	SC200/200BD	SC200/200EB	SC200/200EB-II	SC200/200BZ	Note	
Rate load (kg)	2x2000/2x24 person	2x2000/2x24 person	2x2000/2x24 person	2x2000/2x24 person		
Erecting payload (kg)	2 x 1000					
Rated speed (m/min)	0 - 40		0 - 46	0 - 68		
Reduction ratio	1:16		1:14	1:10		
Max.lifting height(m)	500					
Cage size(L x W x H)(m)	3.2 x 1.5 x 2.5					
Power supply (V)	380 ± 5% 50Hz					
Motor power (kW)	2 x 3 x 11	2 x 2 x 13	2 x 2 x 13	2 x 3 x 18.5	JC=25%	
Rated current (A)	2 x 3 x 34	2 x 2 x 27	2 x 2 x 27	2 x 3 x 38.5		
Power capacity (KVA)	2 x 49	2 x 40	2 x 45	2 x 80		
Mast section	Wall thickness of corner bar (chord member)		Weight of mast section		Dimension of mast section	
	t4.5		145			650 x 650x 1508
	t6.0		160			
	t8.0		180			
t10.0		195				
Cage weight (incl. driving system)(kg)	2 x 2000	2 x 2000	2 x 2000	2 x 2500		
Safety device type	SAJ40 - 1.2	SAJ40 - 1.2	SAJ40 - 1.2	SAJ50 - 2.0		

MAX. TIE-IN INTERVAL AND MAX. CANTILEVER HEIGHT



Designation Series	DESIGNATION	TYPE I	TYPE II	TYPE III	TYPE IV
Max.Tie-in interval L ₁ (m)	Tower height <100m	9	10.5	10.5	10.5
	100m<Tower Height<150m	7.5	9	9	9
	150m<Tower Height <300m		9		
	Tower Height>300m		7.5		
Max.Cantilever height L ₂ (m)	Tower Height<100m	7.5	7.5	7.5	7.5
	100m<Tower Height<150m	6	7.5	7.5	7.5
	150m<Tower Height <300m		7.5		
	Tower Height>300m		6		

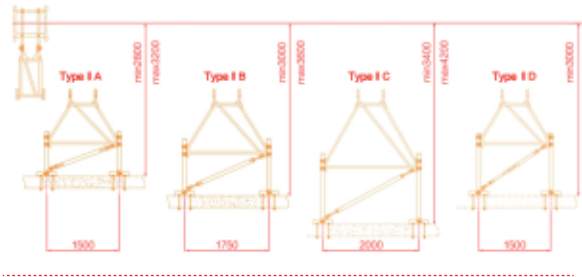

Mast - tie II Structure
Mast - tie II is recommended for its wide application, reasonable structure and reliable connection.

Technical Data (General type)

Dimension of mast section	No. of mast section	Erecting height	150m	260m	380m	500m
76 x 4.5 mm			100	93	93	93
76 x 6.0 mm			0	80	80	80
76 x 8.0 mm			0	0	79	80
76 x 10.0 mm			0	0	0	79
Total of mast sections			100	173	252	332

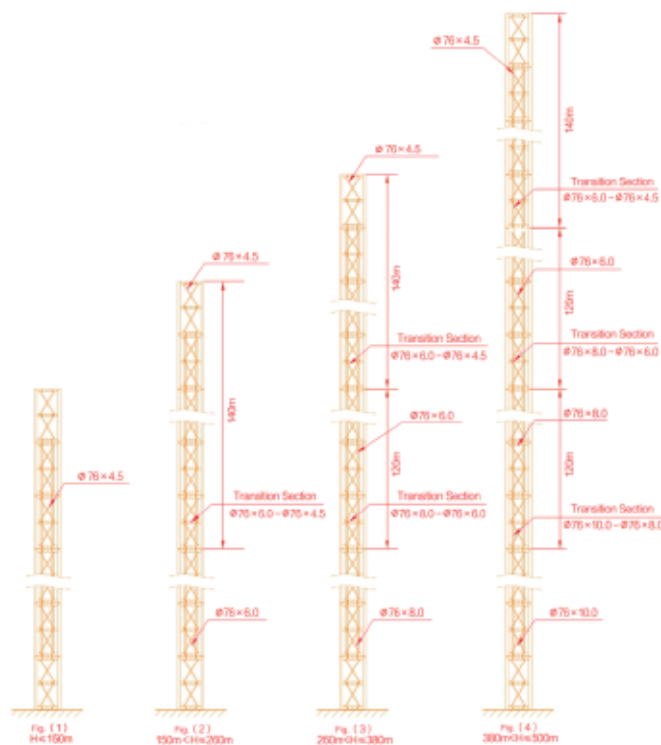

Mast Section Wall Thickness Configuration

DRIVING SYSTEM

The motor and gearbox to be equipped vary subject to specific model of construction hoist.



CAGE

Cage inner space: L x W x H(m): 3.2 x 1.5 x 2.5



MAST

Mast section dimension (mm): 650 x 650 x 1508



DRIVING SYSTEM

Base frame enclosure: _Door sill height 450mm (drum type)
_Door sill height 950mm (pulley type)

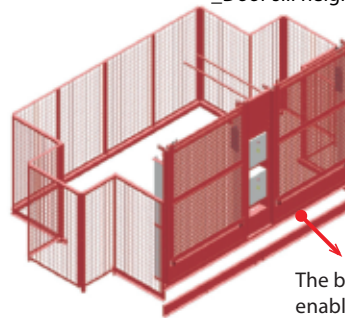

The bended U-bar enables the enclosure interchange of roll drum type and pulley type.

No.	Designation		L(m)	W(m)	H(m)	Weight per piece(t)	Note
1.	Cage		3.4	2.6	3	1.495	With cab
			3.4	1.8	3	1.395	Without cab
2.	Driving System		1.7	0.55	1.2	0.72	SC200 Triple driving units
			1.5	0.55	1.2	0.504	SC100 Twin units
			1.8	0.55	1.1	0.755	SC200 Twin units
3.	Mast section		1.55	0.8	0.8	0.145	
4.	Driving unit		1.1	0.4	0.5	0.165	
			1.1	0.4	0.5	0.177	

MAX. TIE-IN INTERVAL AND MAX.CANTILEVER HEIGHT



No.	Designation	Dimension	L(m)	W(m)	H(m)	Weight per piece(t)	Note
5.	Mast-tie II A		3.4	0.1	2	0.135	
	Mast-tie II B		3	0.1	2.2	0.145	
	Mast-tie II C		3.8	0.1	2.4	0.160	
	Mast-tie II D		3.2	0.1	2	0.140	
6.	Base frame enclosure I		6.1	3.7	3.15	0.109	For cable drum
	Base frame enclosure II		6.1	3.7	1.65	1.202	For cable pulley

Container Loading Solutions

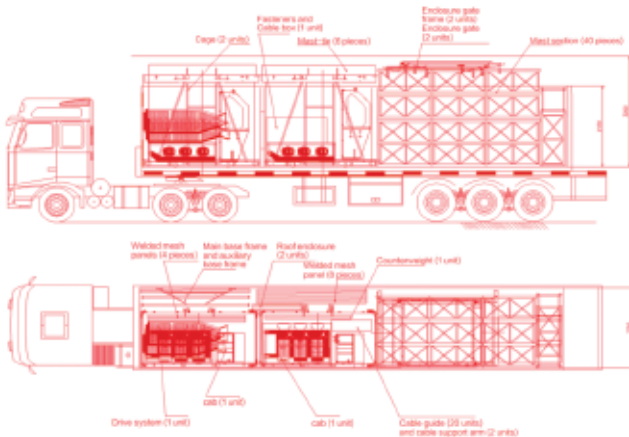

Container Loading Sketch

ERECTING HEIGHT /M	CONTAINER LOADING SOLUTIONS
60	One 40' OT Container, one 20' GP container
70	One 40' OT Container, one 20' GP container
80	One 40' OT Container, one 20' GP container
90	One 40' OT Container, one 20' GP container
100	One 40' OT Container, one 20' GP container
110	One 40' OT Container, one 40' GP container
120	One 40' OT Container, one 40' GP container
150	One 40' OT Container, one 40' GP container
170	One 40' OT Container, one 40' GP container, one 20' GP container

Construction Hoist Truck Loading Solutions



Truck Loading Sample

Note: The truck type and loading plan vary subject to different erecting height of construction hoist.

TRUCK TYPE	SOLUTION I	SOLUTION II
7.2 m	2 cages (incl.accessories)	36 mast sections
9.6m	2 cages (incl.accessories) + 12 mast sections	54 mast sections
13.5m	2 cages (incl.accessories) + 40 mast sections	96 mast sections
17.5m	2 cages (incl.accessories) + 66 mast sections	126 mast sections







ASCENSOR
DE OBRA

SC
SERIES



HEAVY DUTY S.A.
Panamericana Norte Km 25
Lampa, Santiago
CHILE

Tel: (+56 2) 2 952 7800
E-mail: info@heavyduty.cl

www.heavyduty.cl

Representantes exclusivos en Chile de:

